

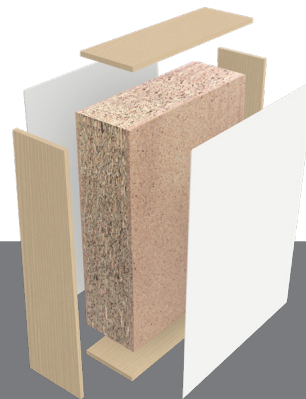

# HALSPAN®



## Prima FD60 54mm

### Fire Rated Interior Grade Door Blanks

**Prima** internal fire door blanks feature Halspan's unique 3-layer particle board. Specifically designed for the purpose, using a complex combination of chemical and engineering development, these blanks produce doors of altogether superior quality, strength and overall performance.



#### Fire Rating FD60

Tested in Accordance with:	BS 476: Part 22: 1987, BS EN 1634-1:2000/2008 & BS EN 1363-1:1999		
Maximum Approved Sizes*  * Maximum approved sizes based on timber door frames. Please refer to certification reports for the corresponding widths and heights.	Single Doors	Maximum height: 2921mm*	
		Maximum width: 1385mm*	
	Double Doors	Maximum height: 2831mm*	
		Maximum width: 1133mm*	
Approved Frames	Timber Hardwood, MDF, Steel		
Approved Glazing Size	0.82m²		
Panel Effect	Yes		
Feature Grooves	Yes		



#### Acoustics

<b>Tested in Accordance with:</b>	BS EN ISO 10140-2:2010	
<b>Acoustic Performance</b>	Single Doors	Unglazed 34dB/Rw
		Glazed 36dB/Rw
	Double Doors	Unglazed 33dB/Rw
		Glazed 35dB/Rw



#### Environmental

U-value (Wm2K)	Heat loss per m² 1.6 (doorset)	<div><p>Look for our FSC® certified products</p></div>
Formaldehyde Release Rating	0.05ppm when tested to EN 717-1 Classification - BS EN 13986 (2004) - Class E1 (max 0.1ppm)	
	E05 Grade  0.07ppm when tested to ASTM E1333 Classification - CARB II (2010) compliant (max 0.09ppm)	



#### Operational & Durability

<b>Tested in Accordance with:</b>	DD 171, EN 1191, EN 1192, EN 947, EN 949 & EN 950
<b>Enhanced security performance requirements of door set</b>	Tested to comply with PAS 24



#### General Properties

<b>Weight</b>	34 kg/m <sup>2</sup>
<b>Density (±10%)</b>	630 kg/m <sup>3</sup>
<b>Moisture Content</b>	Ex factory 6-12%

# Prima FD60 54mm

Fire Rated Interior Grade Door Blanks



## Design Criteria

Stock Board Sizes	2135 x 915 mm 2800 x 915 mm 2440 x 1220 mm 3050 x 1050 mm 2440 x 915 mm 2050 x 826 mm 2050 x 926 mm 2800 x 1830mm	Timber Lipping Glue Lines		UF PU Hotmelt PUR
		Flat Timber Lippings	3 - 18 mm thick	
		Rebates (Timber Lippings (double doors))	15 - 25 mm thick	

## Doorset Configurations

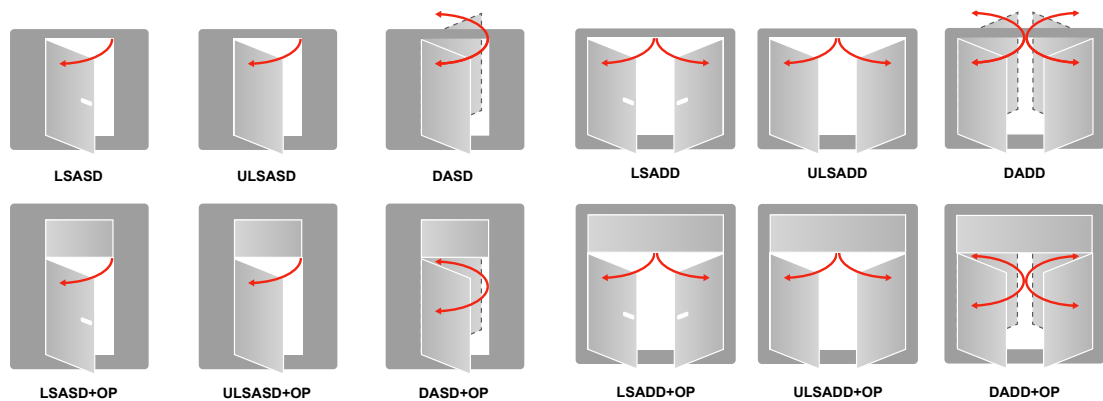

## Design Options

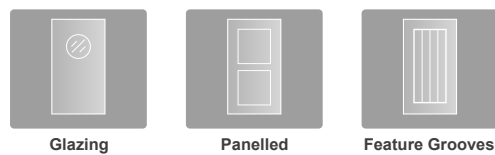

## Seals & Hardware

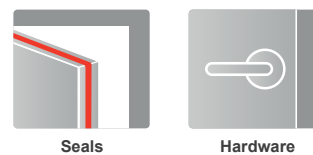

Refer to relevant product third party scope data and literature for further information. For technical guidance please contact the technical support team - [technical@halspan.com](mailto:technical@halspan.com)

The information in this brochure is correct at time of going to press however our designs, specifications and certifications may change in the interest of product development following publication. If you would like to make a query about any of the details in this document, please contact Halspan via our website, or call our office in the UK on +44 (0)3300 563836.

