

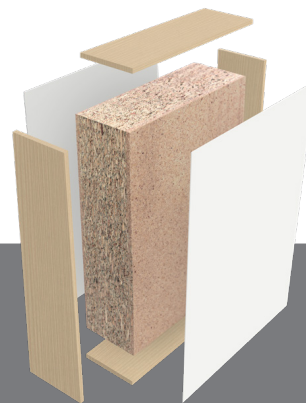

HALSPAN®



Optima FD60 54mm

Fire Rated Interior Grade Door Blanks

Optima internal fire door blanks feature Halspan's unique 3-layer particle board. Specifically designed for the purpose, using a combination of chemical and engineering development, these blanks produce doors of altogether excellent quality, strength and overall performance.



Fire Rating FD60

Tested in Accordance with:	BS 476: Part 22: 1987, BS EN 1634-1:2000/2008 & BS EN 1363-1:1999		 
Maximum Approved Sizes* * Maximum approved sizes based on timber door frames. Please refer to certification reports for the corresponding widths and heights.	Single Doors	Maximum height: 3050mm*	
		Maximum width: 1384mm*	
	Double Doors	Maximum height: 2850mm*	
		Maximum width: 1142mm*	
Approved Frames	Timber Hardwood, MDF, Steel		
Approved Glazing Size	0.82m²		
Panel Effect	No		
Feature Grooves	Yes		



Acoustics

Tested in Accordance with:	BS EN ISO 10140-2:2010	
Acoustic Performance	Single Doors	Unglazed 34dB/Rw
		Glazed 35dB/Rw
	Double Doors	Unglazed 33dB/Rw
		Glazed 35dB/Rw



Environmental

U-value (Wm2K)	Heat loss per m ² 1.8 (doorset)	 Look for our FSC® certified products The mark of responsible forestry
Formaldehyde Release Rating	BS EN 13986 (2004) – Class E1 CARB II E05 Grade	



Operational & Durability

Tested in Accordance with:	DD 171, EN 1191, EN 1192, EN 947, EN 949 & EN 950
Enhanced security performance requirements of door set	Tested to comply with PAS 24



General Properties

Weight	33.5kg/m ²
Density (±10%)	620 kg/m ³
Moisture Content	Ex factory 6-12%

Optima FD60 54mm

Fire Rated Interior Grade Door Blanks



Design Criteria

Stock Board Sizes	2135 x 915 mm 2440 x 915 mm 2440 x 1220 mm 2050 x 826 mm 2050 x 926 mm 2800 x 915 mm 2800 x 1830 mm 3050 x 1050 mm	Lipping Glue Lines	UF PU Hotmelt PUR
		Flat Timber Lippings	6 - 18 mm thick
		Rebated Timber Lippings (double doors)	20 - 30mm thick
		Standard Intumescent	Palusol Graphite

Doorset Configurations

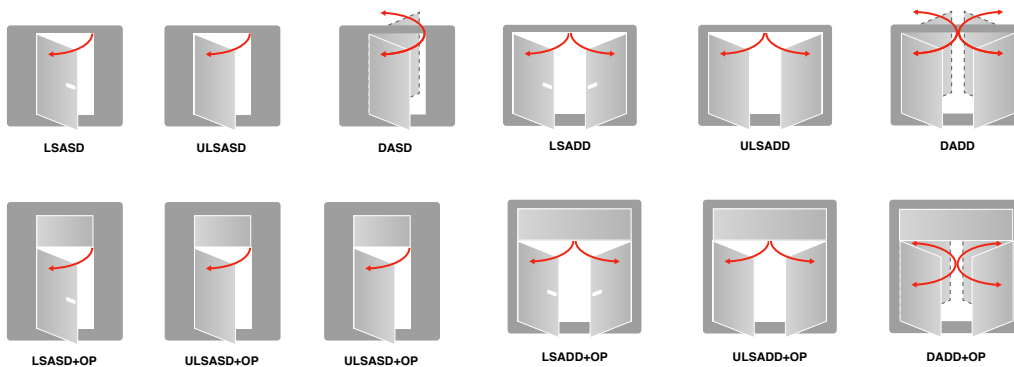

Design Options

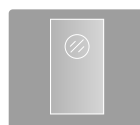

Glazing

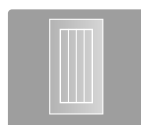

Feature Grooves



Seals



Hardware

Seals & Hardware

Refer to relevant product third party scope data and literature for further information. For technical guidance please contact the technical support team - technical@halspan.com

The information in this brochure is correct at time of going to press however our designs, specifications and certifications may change in the interest of product development following publication. If you would like to make a query about any of the details in this document, please contact Halspan via our website, or call our office in the UK on +44 (0)3300 563836.

